

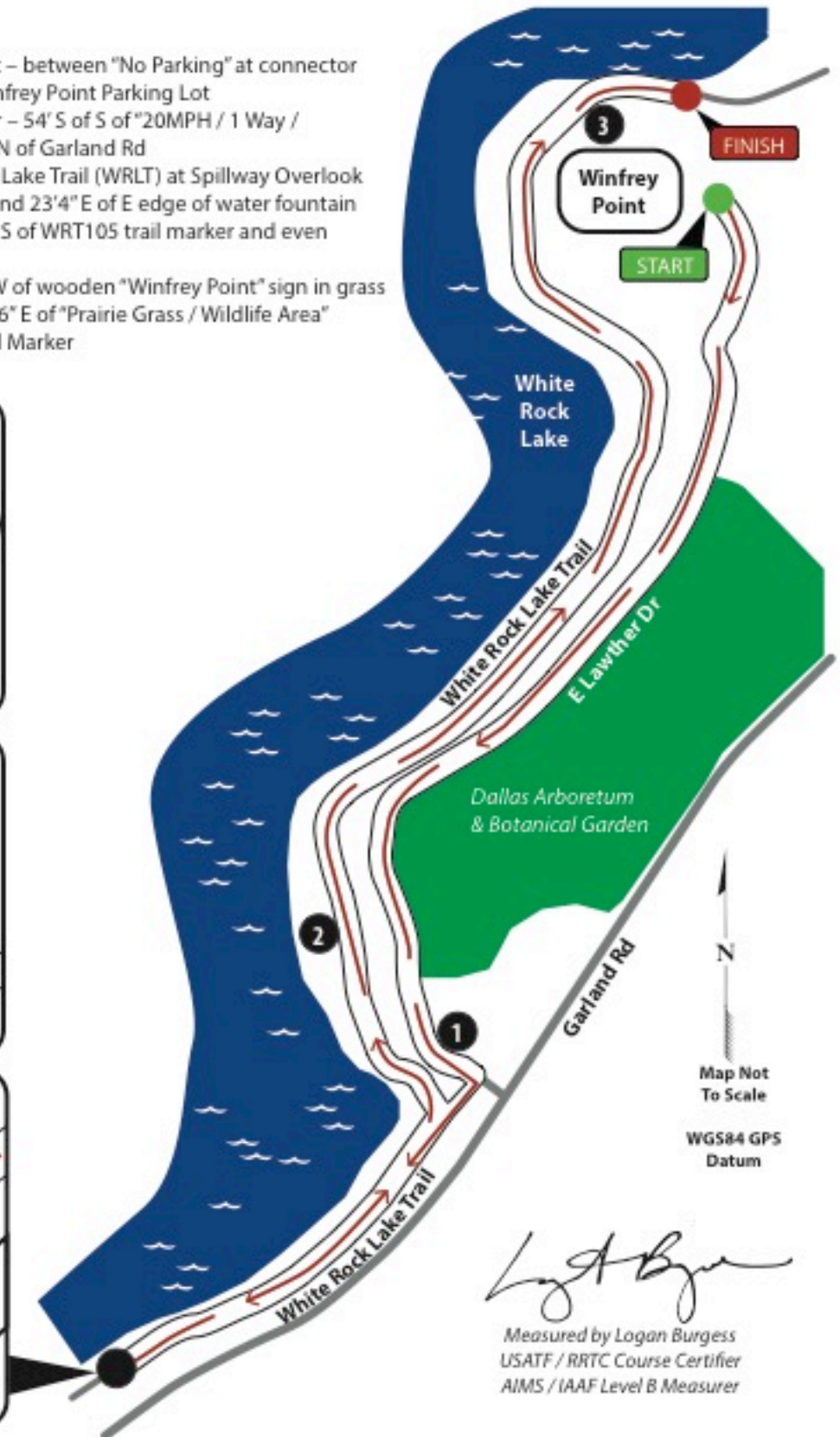

**5 km - USATF Certification TX15033LAB - Dallas, TX**  
**Effective 04.05.2015 to 12.31.2025**  
**Measured by Logan Burgess on 04.04.2015**  
**Map not to Scale - No Restrictions**

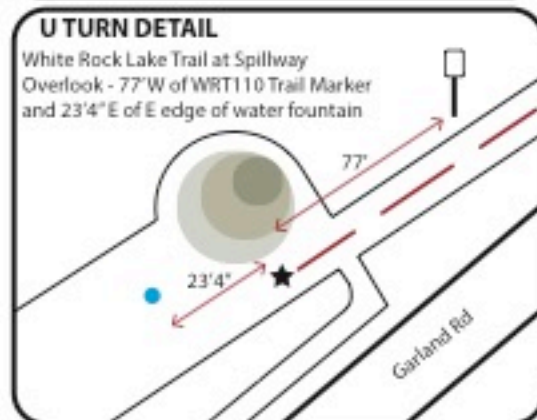

- Start** - (N32 49.841 W96 42.919) - Winfrey Point - between "No Parking" at connector between E Lawther Dr and Winfrey Point Parking Lot
- Mile 1** - (N32 49.125 W96 43.141) - E Lawther Dr - 54' S of S of "20MPH / 1 Way / No Parking" sign immediately N of Garland Rd
- U Turn** - (N32 48.886 W96 43.453) - White Rock Lake Trail (WRLT) at Spillway Overlook 77' W of WRT110 Trail Marker and 23'4" E of E edge of water fountain
- Mile 2** - (N32 49.213 W96 43.217) - WRLT - 209' S of WRT105 trail marker and even with sign at trash can cluster
- Mile 3** - (N32 49.906 W96 43.008) - WRLT - 35' W of wooden "Winfrey Point" sign in grass
- Finish** - (N32 49.923 W96 42.909) - WRLT - 125'6" E of "Prairie Grass / Wildlife Area" sign and 178' E of WRT181 Trail Marker

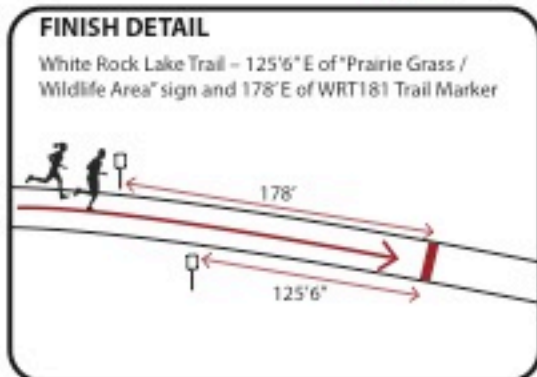
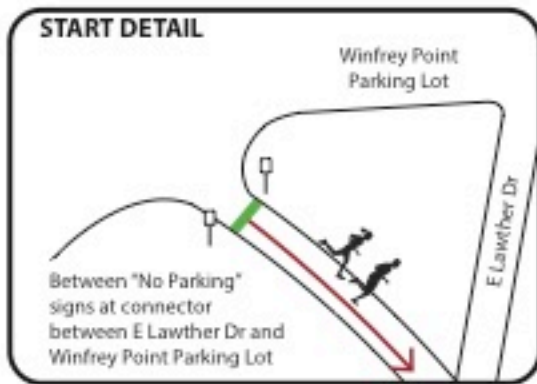

*Logan Burgess*

Measured by Logan Burgess  
 USATF / RRTC Course Certifier  
 AIMS / IAAF Level B Measurer